



154 Ridgway Road, Luton, LU2 7RT
£1,600 PCM

- EXCLUSIVE TO PR PROPERTY LETTINGS
- DOWNSTAIRS WC
- CLOSE TO TRAIN STATION
- 3 BEDROOMS
- PRIVATE REAR GARDEN
- AVAILABLE NOW
- 2 RECEPTION ROOMS
- CLOSE TO TOWN CENTER
- MUST BE VIEWED

**** Exclusive to PR Property **** A well-located 3 bedroom house to rent on Ridgway Road, Luton, offering flexible living space with two reception rooms and a private rear garden. Set within easy reach of the town centre and Luton station, it's a handy option for commuters and anyone wanting everyday amenities close by. The layout suits a range of lifestyles, whether you need a separate dining space, a home office area, or just a bit of extra room to spread out. Available now and offered with viewings highly recommended to appreciate the space and setting.

ENTRANCE HALL

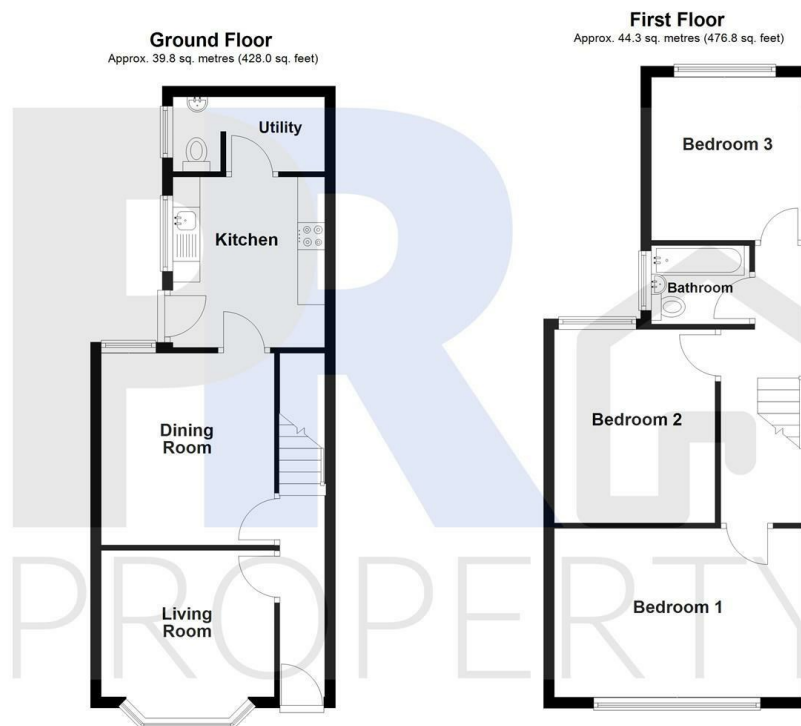

Total area: approx. 84.1 sq. metres (904.8 sq. feet)
154 Ridgway Road, Luton

Energy Efficiency Rating		
	Current	Potential
Very energy efficient - lower running costs		
(92 plus) A		
(81-91) B		
(69-80) C		
(55-68) D		
(39-54) E		
(21-38) F		
(1-20) G		
Not energy efficient - higher running costs		
England & Wales		EU Directive 2002/91/EC